



AMERICAN ATHLETIC, INC
200 AMERICAN AVE.
JEFFERSON, IOWA 50129
PHONE 515-386-3125



**BB-604-RNA
CLASSIC SERIES
REFLEX NON-ADJUSTABLE
BALANCE BEAM**

MODEL NUMBER 406430	LAST REVISION DATE 10-29-99	INSTRUCTION NO. 81832
-------------------------------	---------------------------------------	---------------------------------

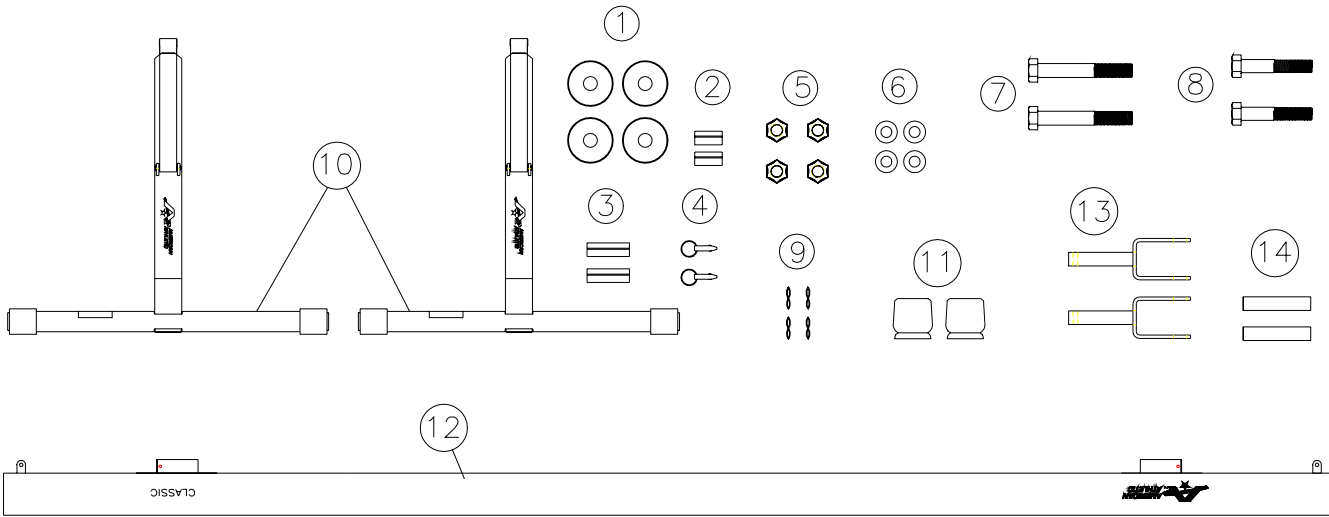

KEY	PART NO.	DESCRIPTION	QTY
1	0019149	REFLEX ROLLER	4
2	0020120	13 MM X 26 MM SPRING PIN	2
3	0020122	13 MM X 45 MM SPRING PIN	2
4	0020128	3/16" X .7 QUICK RELEASE PULL PIN	2
5	0020391	3/8-16 CENTER LOCK NUT	4
6	0020399	3/8 NARROW FLAT WASHER	4
7	0020561	3/8-16 X 3-1/2 HEX HEAD CAP SCREW	2
8	0020527	3/8-16 X 3-1/4 HEX HEAD CAP SCREW	2
9	0021420	STOCK WAVE WASHER	4
10	0072428	BEAM BASE ASSEMBLY	2
11	0072451	300 LB BUMPER – REAMED	2
12	0072505	BEAM ASSEMBLY	1
13	0072484	BUMPER RETAINER WELDMENTS	2
14	0072486	REFLEX AXLE	2

YOUR CLASSIC REFLEX NON-ADJUSTABLE BALANCE BEAM COMES TO YOU IN 2 PACKAGES:

- (1) #406441 BEAM BASE PACKAGE
- (1) #406432 BEAM PACKAGE

MAKE SURE YOU HAVE RECEIVED ALL THE PARTS BEFORE DISCARDING PACKAGING. THE PARTS BAG IS INCLUDED IN THE CRATE WITH THE BEAM ASSEMBLY.

TO BEGIN ASSEMBLY

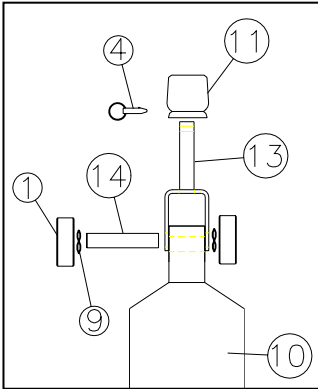

1. After all parts are unpackaged, lay the beam assembly upside down on the cardboard packaging material to keep the performance surface clean.
2. You will need to locate 2 reflex rollers (no. 1), 2 stock wave washers (no. 9), 1 bumper retainer weldment, 1 reamed bumper (no. 11) and 1 reflex axle (no. 14).
3. Assemble the above parts to the beam base as shown to the left. The pull pin will not get assembled until the base is positioned into the reflex channels of the beam assembly.

4. Slide the beam base assembly carefully into the reflex channel.
5. Line the reflex bumper weldment with the hole in the end of the reflex channel. Insert the quick release pull pin (no.4) through the hole in the end of the weldment as shown above.

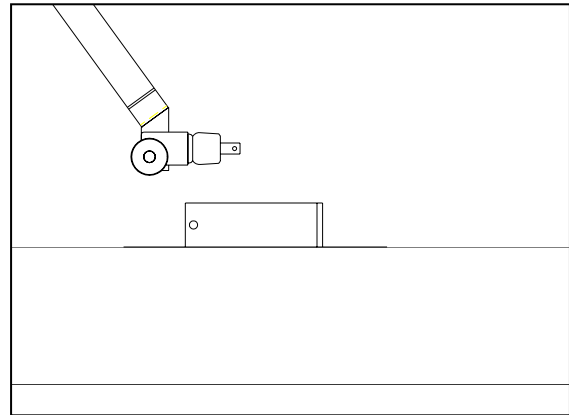

6. When the leg has been inserted into the reflex channel, insert the 3/8" x 3-1/2" cap screw through the holes in the rear of the reflex channel and assemble the 3/8" center lock nut. Tighten securely.
7. Next insert the brace rod between the ears on the end of the beam plate. Tap a 13 mm x 26 mm spring pin (no. 2), which is about 1" long, through one ear. Tap a 13 mm x 45 mm spring pin (no. 3), which is about 1-3/4" long, through the other ear until they meet and are centered.
8. Slide a 3/8" washer (no. 6) onto the 3/8 x 3-1/4" cap screw and insert through the spring pins. Slide another 3/8" washer on the other side before installing 3/8" center lock nut. Tighten down securely. (the washers against the spring pins should allow you to tighten down without affecting the free movement of the brace arm during adjustment and reflex action.)
9. Repeat above procedure for the other end of the balance beam.
10. Turn the beam over, taking care not to turn one side without turning the other side at the same time.

USING YOUR BB-604-RNA BALANCE BEAM

- ✓ *Always use safety mats beneath the beam and at both ends. Fig recommends 20 cm mats for beam competition.*
- ✓ *American Athletic manufactures beam filler pads that fill the space created between a 15-1/2' mat under the beam and a mount or dismount mat on either end of the beam. These leg pads cover a width of 8' and connect with velcro flaps. Model no. 416385 is for 18 cm filler pads and 416380 are for 12 cm filler pads.*
- ✓ *To further assure safety, you may choose to pad the legs. American Athletic manufactures beam leg pads that fit this beam (part #416390).*

Periodically check parts for wear and contact the factory for replacements